

PROPOSED BASEMENT FLOOR PLAN
SCALE 1:50

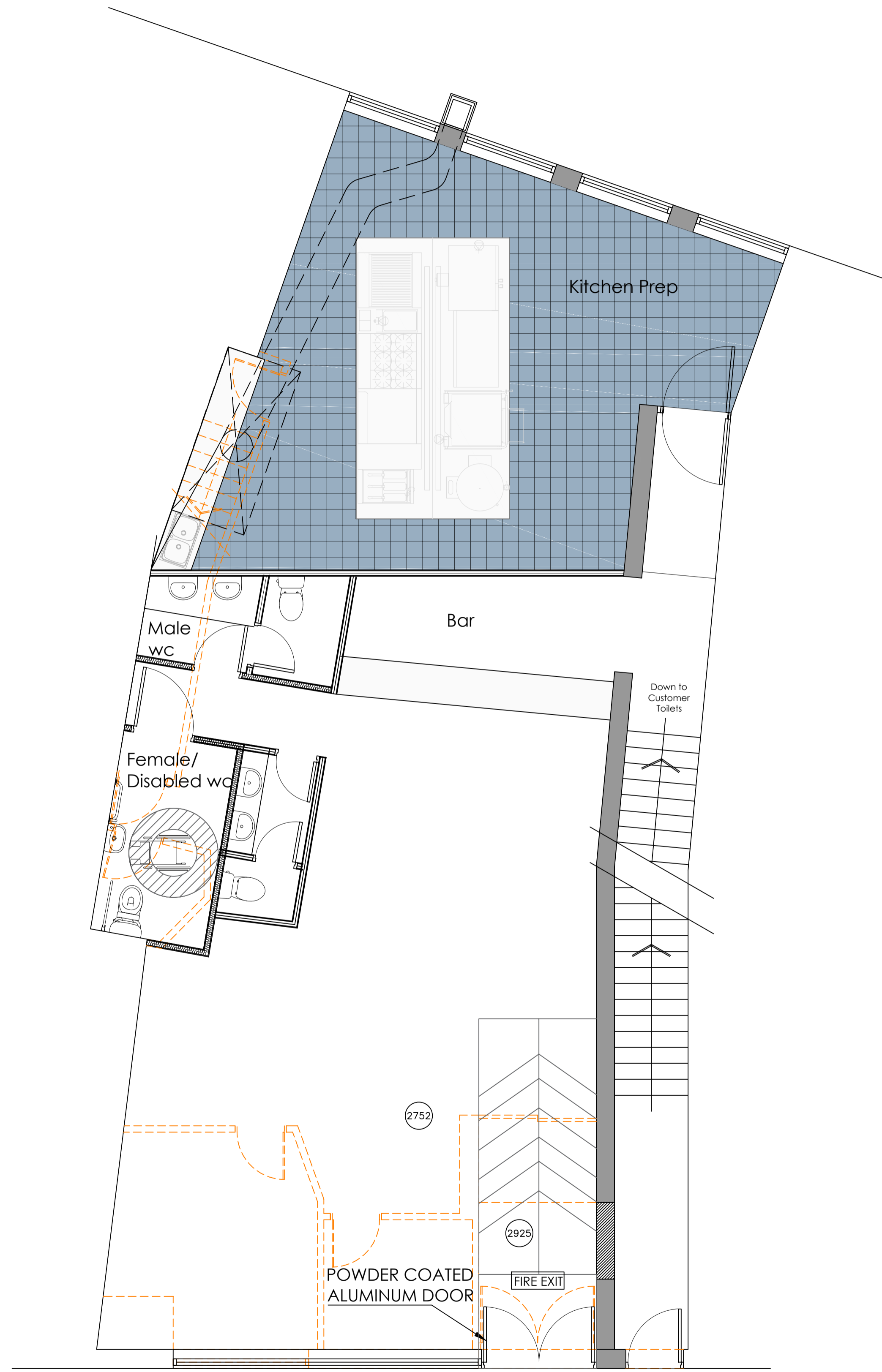

PROPOSED GROUND FLOOR PLAN
SCALE 1:50

EXISTING ENTRANCE TO BE ALTERED TO PROVIDE RAMPED ACCESS OF GRADIENT 1:12
Up to Flats

Please note these drawings are for Planning and Building Regulation purposes only.

NOTE:
The contractor is to check and verify all building and site dimensions, levels and sewer invert levels at connection points before works commence.

All drawings must be read with and checked against any structural or other specialist drawings provided. All works to comply with British Standards, Codes of Practice, current Building Regulations and carried out to the satisfaction of Building Inspector. All materials to comply with the relevant British Standards

D	INTERNAL ALTERATIONS REQUESTED BY CLIENT	21/09/2021	SR
C	EXTRACT FLU RELOCATED	26/01/2021	SR
B	MATERIAL NOTICE	03/12/2020	SR
A	FLU & ENLARGED DIS. WC	27/11/2020	SR

REVISIONS	DATE	BY
-----------	------	----

RIYAT ASSOCIATES LTD
Architectural Designers and Planning Consultants

Benson House, 14 Benson Street, Leeds LS7 1BL.
Telephone: 0113 2455492 Fax: 0113 2443800 E-Mail: info@psriyat.com

Client:
Bo-Bo Investment Ltd.

Project
Proposed Change of Use of Ground Floor Bank to Restaurant & 2 no. Flats above at No. 27 Blackwellgate, Darlington, DL1 5HX

Drawing:
Proposed Basement and Ground Floor Plans

Scale: As Shown @ A1	Drawing No. 3036/02
Date: February 2020	
Drawn by: SS	